

# SURVEYOR'S RECORD

Section 24

Township 108

Range 43

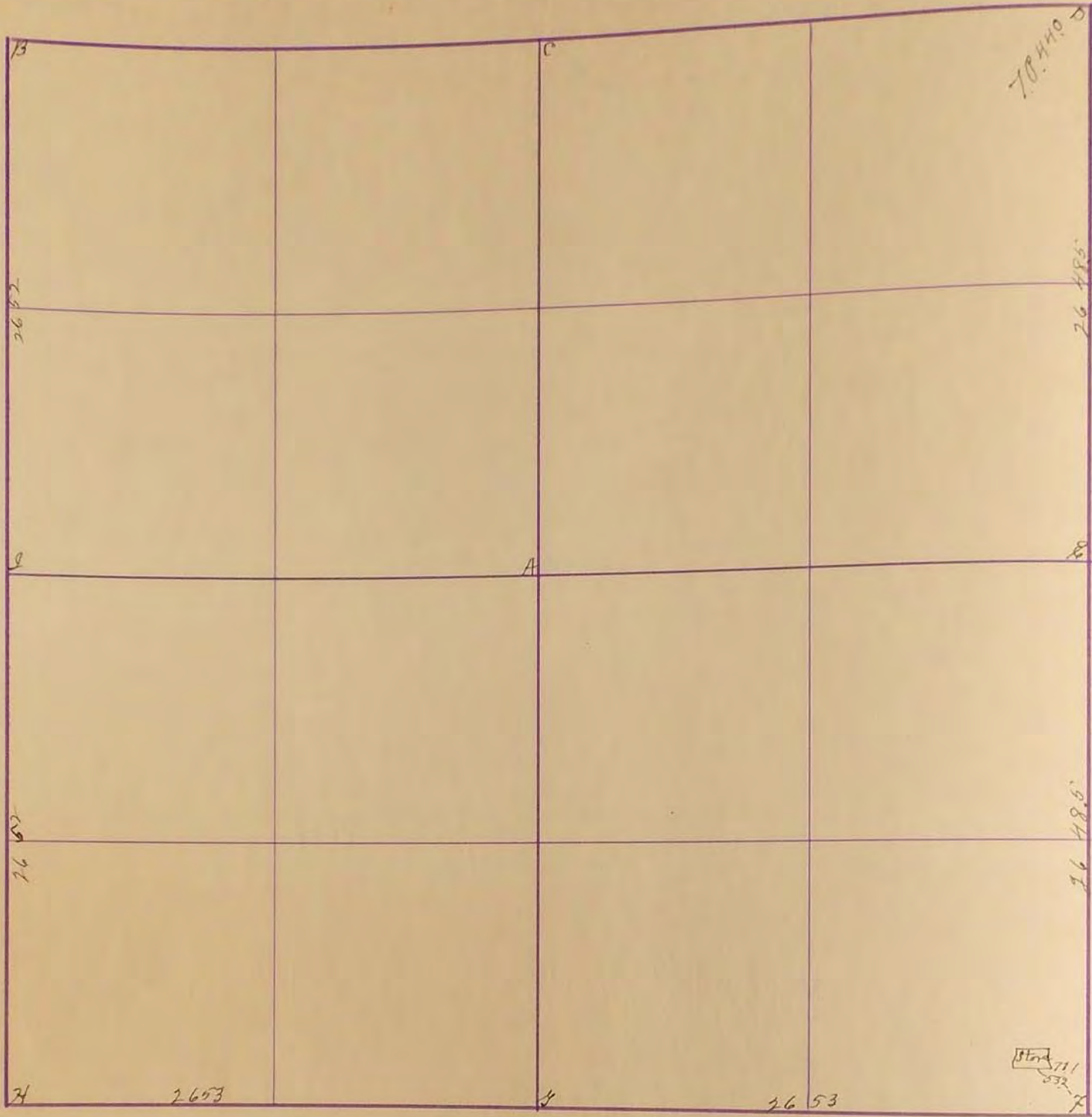

24  
25

June 28-1902 J.H. Hoalstone rpf

B. See Sec. 23

C. 2 Stones F. cor. 31' S. T. 22.5 N.

G. Stone in grade 7. cor. 453 1/2 ft. in center of grade N. 74.84 E.

I. Stone in grade

C. "212 Hub" R.P. Bottle cap in cor. fence post North 513,  
R.P. Bottle cap in fence post N.M. 60.3' (1956)

SURVEY No. \_\_\_\_\_

Section 24

Town 104

Range 43

350 Feet

49.0 Feet

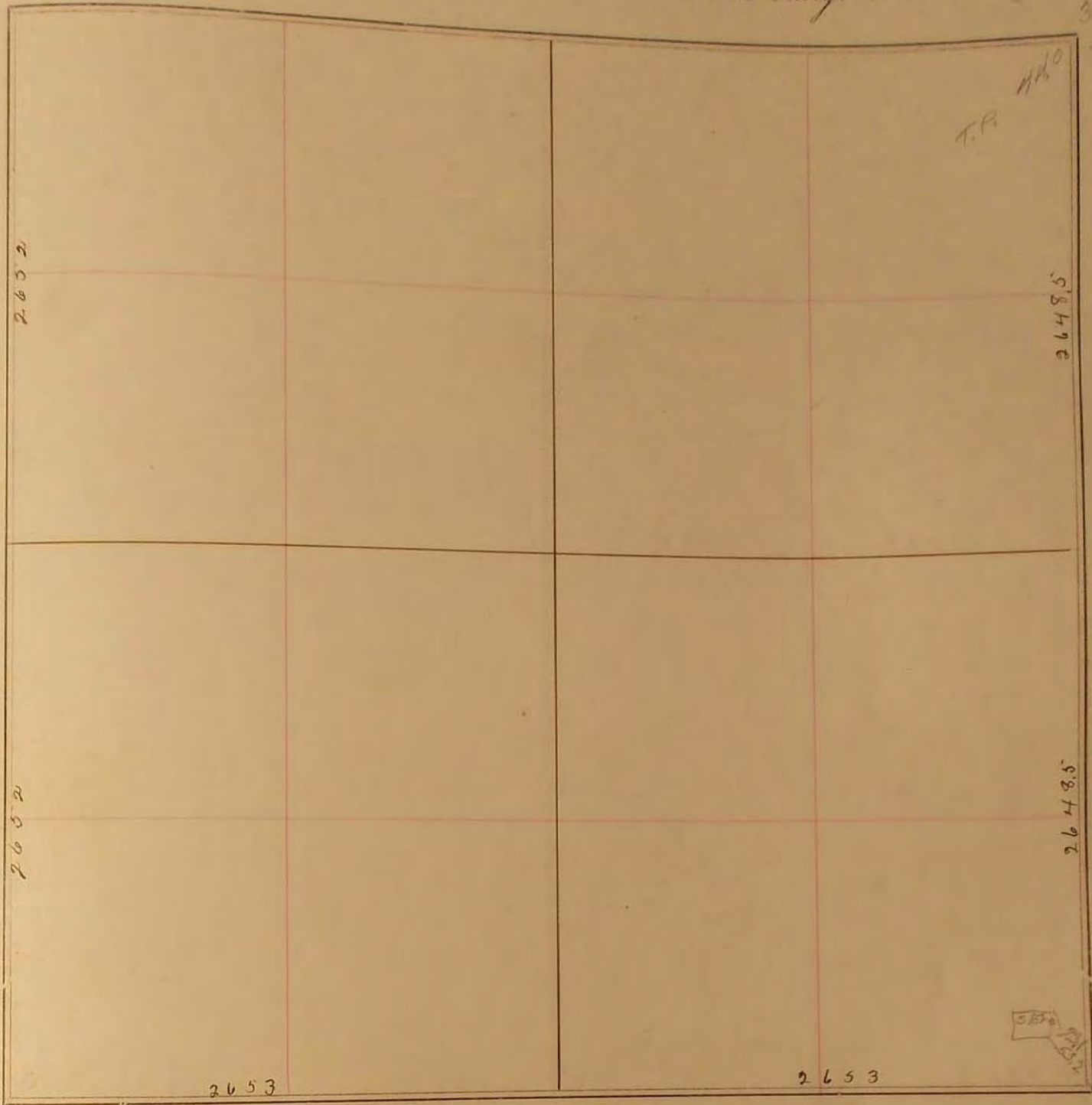

FIELD NOTES.

June, 25, 1902

J.W. Woodstonecraft

B. See Sec. 23

C. 2 stones from 31' S. + 22.5' W.

⊙ stone in grade from cor. 45.3' N.W. in center of grade N + S. + E

1 stone in grade